

## Data Sheet

### Expansion Joint Filler

#### Description

Expansion joint filler is a closed cell expanded polyethylene foam, supplied in sheet form or cut to slab depth/wall thickness as required. Robust, non-absorbent with excellent recoverability of 100% from 50% compression, low load transfer, non extruding and resistant to attack by most acids and alkalis.

#### Application

Expansion joint filler is used in concrete slab construction and brickwork joints and is supplied in either sheet form or standard widths pre-cut to depth of sealant for controlled void formation and easy removal.

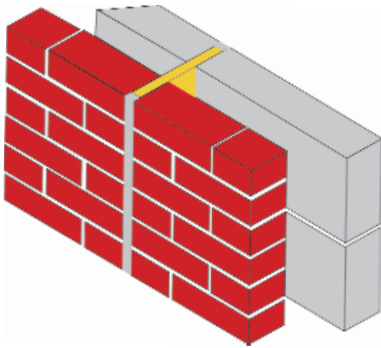

- Expansion joints in concrete slab construction
- Expansion joints in Brick/ Blockwork

#### Sizes:

Thicknesses	Stock Widths
10mm	100mm
12mm	150mm
15mm	200mm
20mm	

n55Plus

Physical Properties	Value	Test Method
Tensile Strength	2.6 Kp/cm <sup>2</sup>	Din 53571
% Elongation	85%	Din 53571
Water absorption after 7 days	Volume %, Negligible	Din 53428
Recovery from 50% Compression	100% After immediate release	Din 53572
After 24 hours Compression	90.4%	Din 53572